



IMPORTANT SAFETY WARNINGS



THE INSTALLATION MUST ONLY BE PERFORMED BY A LICENSED ELECTRICIAN. TO PREVENT DEATH, INJURY OR DAMAGE TO PROPERTY, THIS PRODUCT MUST BE INSTALLED IN ACCORDANCE TO NATIONAL ELECTRIC CODE (NFPA70) IN THE US OR CANADIAN ELECTRICAL CODE (CSA22.1) IN CANADA.

L'INSTALLATION NE DOIT ÊTRE EFFECTUÉE QUE PAR UN ÉLECTRICIEN AGRÉÉ. POUR PRÉVENIR LES DÉCÈS, LES BLESSURES OU LES DOMMAGES MATÉRIELS, CE PRODUIT DOIT ÊTRE INSTALLÉ CONFORMÉMENT AU CODE NATIONAL DE L'ÉLECTRICITÉ (NFPA70) AUX USA OU CODE CANADIEN DE L'ÉLECTRICITÉ (CSA22.1) AU CANADA.

CONSULT A QUALIFIED ELECTRICIAN TO ENSURE CORRECT BRANCH CIRCUIT CONDUCTOR.

CONSULTER UN ÉLECTRICIEN QUALIFIÉ POUR VOUS ASSURER QUE LES CONDUCTEURS DE LA DÉRIVATION SONT ADÉQUATS.

CAUTION – RISK OF FIRE. MIN 75°C (167°F) SUPPLY CONDUCTORS.

ATTENTION – RISQUE D'INCENDIE. LES FILS D'ALIMENTATION 75°C (167°F) MIN.

- To reduce the risk of death, personal injury or property damage from fire, electric shock, falling parts, cuts/abrasions, and other hazards please read all warnings and instructions included with the fixture box and labels.
- Follow all manufacturer's warnings and restrictions for: driver type, burning position, mounting locations/methods, replacement and recycling.
- Wear gloves and safety glasses at all times when removing luminaire from carton, installing, servicing or performing maintenance.
- Disconnect or turn off power before installation or servicing the luminaire.
- Allow fixture to cool before handling.
- Do not exceed maximum wattage marked on the label.
- Do not operate in close proximity to persons, combustible materials or substances affected by heat or drying.
- Verify that supply voltage is correct by comparing it with label information.
- Wiring connections should be capped with UL-approved wire connectors.
- DO NOT INSTALL DAMAGED PRODUCT! This luminaire has been properly packed so that no parts should have been damaged during transit. Inspect to confirm. Any part damaged during or after assembly should be replaced.
- Maintenance should be performed by person(s) familiar with the luminaires' construction and operation and any hazards involved. Regular fixture maintenance programs are recommended.
- It will occasionally be necessary to clean the outside of the refractor/lens. Frequency of cleaning will depend on ambient dirt level and minimum light output which is acceptable to user. Refractor/lens should be washed in a solution of warm water and any mild, non-abrasive household detergent, rinsed with clean water and wiped dry.
- Should optical assembly become dirty on the inside, wipe lens and clean in above manner, replacing damaged gaskets as necessary.
- These instructions do not purport to cover all details or variations in equipment nor to provide every possible contingency to meet in connection with installation, operation, or maintenance.

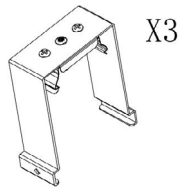

Recessed Holding Bracket

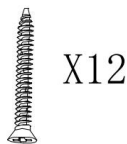

Tapping Screw

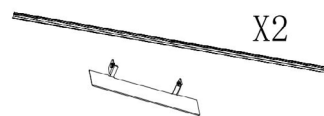

Recessed Trim Aluminum Flange

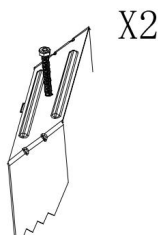

Recessed Rotatable Holding Bracket

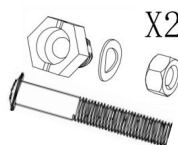

Anchor Bolt

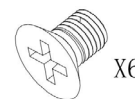

Screws for recessed holding bracket



Screw

Specifications and dimensions subject to change without notice.

TRIM RECESSED MOUNT INSTALLATION

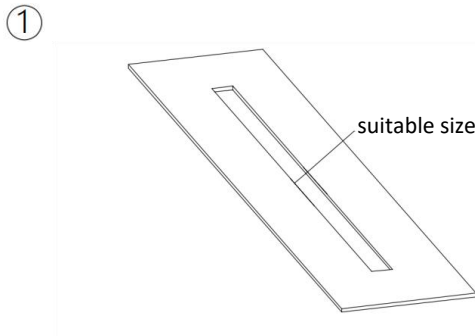

1. Cut a slot in the ceiling to accommodate the size of the linear fixture.

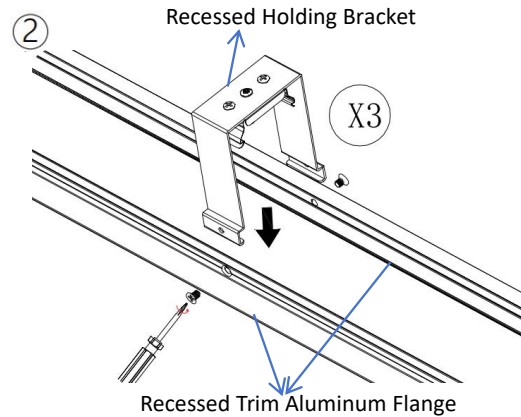

2. Screw the Recessed Holding Bracket to the Recessed Trim Aluminum Flange.

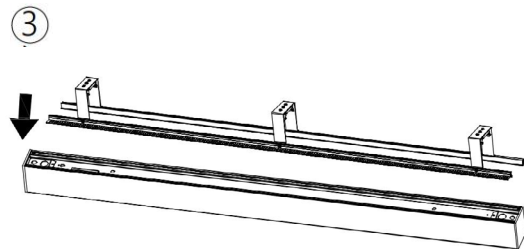

3. Bring the Trim recessed bracket over fixture and press down on end brackets to mount spring clips onto the linear fixture. Screw assembly by screwing down bolts on recessed trim brackets.

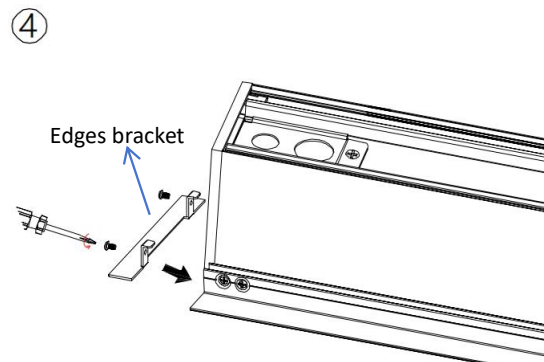

4. Install the edges bracket to the Recessed Trim Aluminum Flange.

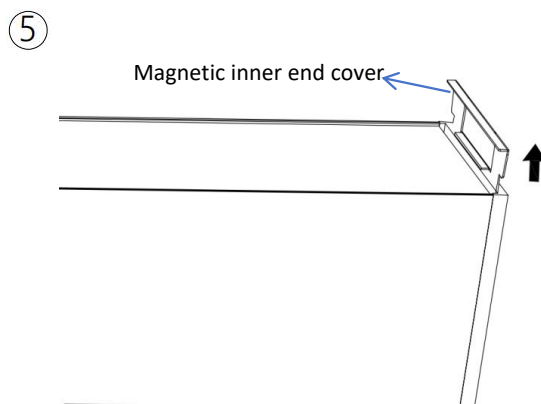

5. Pull out the magnetic inner end cover.

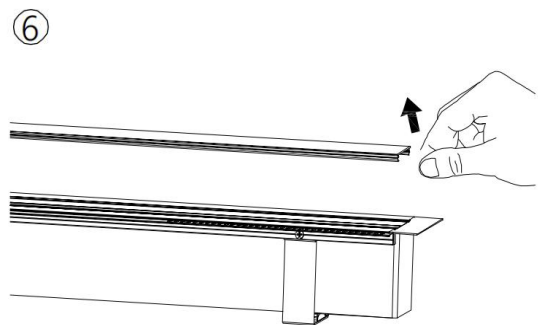

6. Carefully take out the lens on the front exposing the LED board.

Specifications and dimensions subject to change without notice.

TRIM RECESSED MOUNT INSTALLATION

⑦

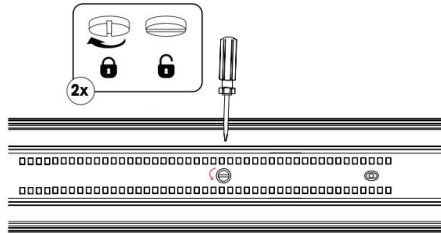

7. Use a flat screwdriver to rotate the screws on the LED board from lock to open status, do it on both side.

⑧

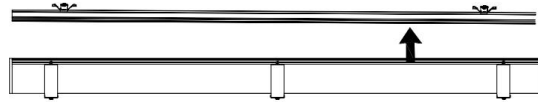

8. Take out the gear tray module from the linear fixture.

⑨

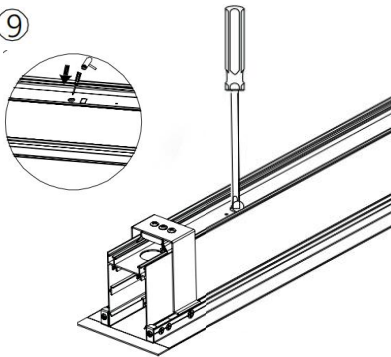

9. Use mallet and a flat-head screwdriver to punch two small knockouts on the top of fixture.

⑩

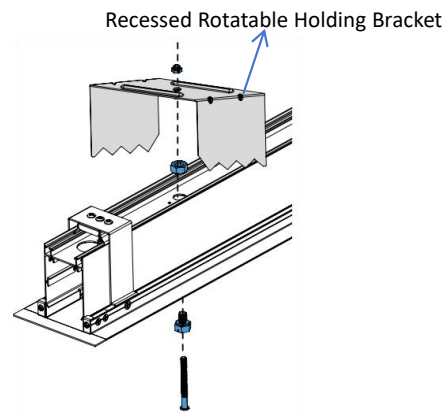

10. Insert Recessed Rotatable Holding Bracket through the knock-out holes, secure the bracket with anchor bolts through the knock-out holes.

⑪

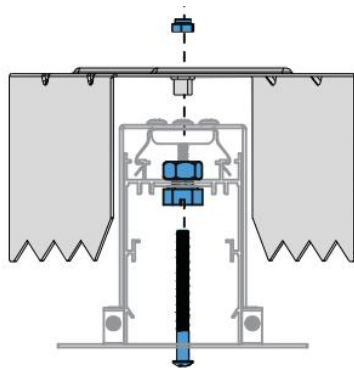

11. Profile of linear fixture's cross-section.

⑫

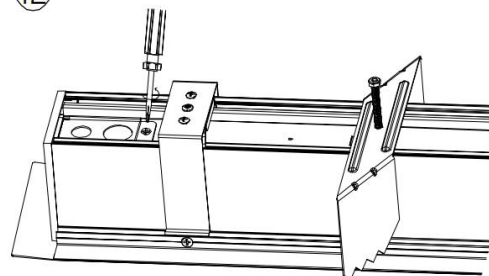

12. Use a screwdriver to remove the knockout plate from the fixture.

TRIM RECESSED MOUNT INSTALLATION

13

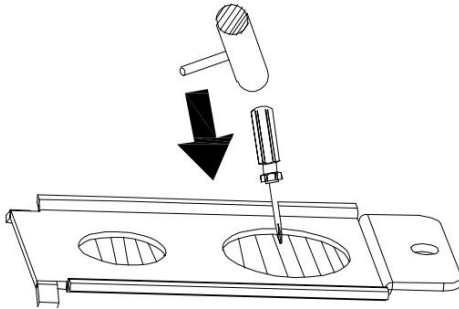

13. Use mallet and a flat-head screwdriver to punch one of the knock-out from knockout plate.

14

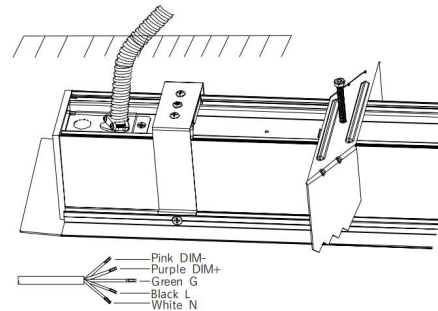

14. Connect supply wires to 5 wire cables matching color of the wires and fixed on the knockout plate.

15

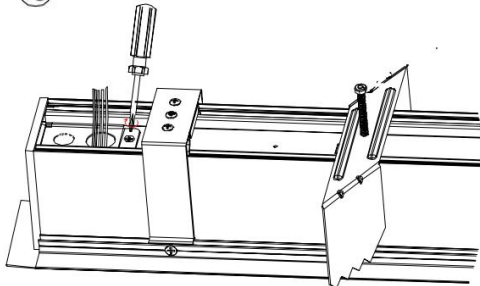

15. Secure the knockout plate with the screw.

16

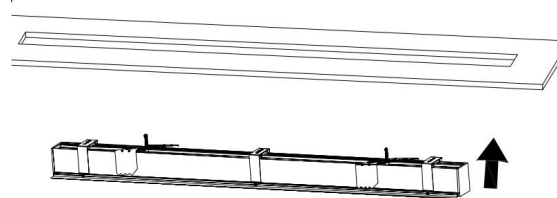

16. Insert fixture with recessed trim kit into pre-cut slot.

17

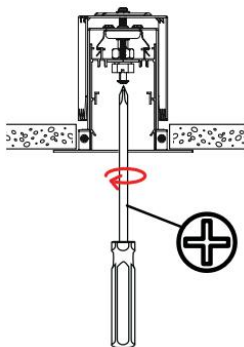

17. Use the screwdriver to tighten the bolts.

18

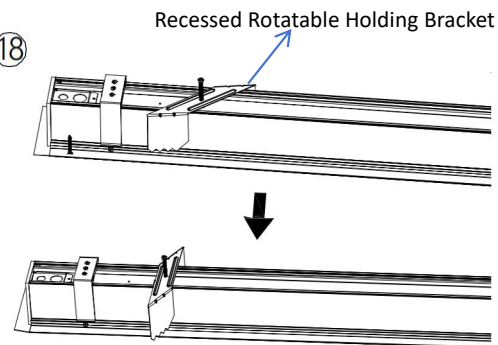

18. Fully tighten the bolts to secure the Recessed Rotatable Holding Bracket to perpendicular to the fixture so that stuck in the ceiling to prevent dropping.

TRIM RECESSED MOUNT INSTALLATION

19

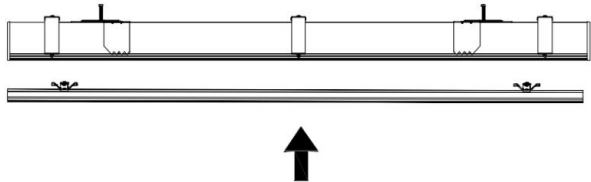

19. Put the gear tray module back into the linear fixture.

20

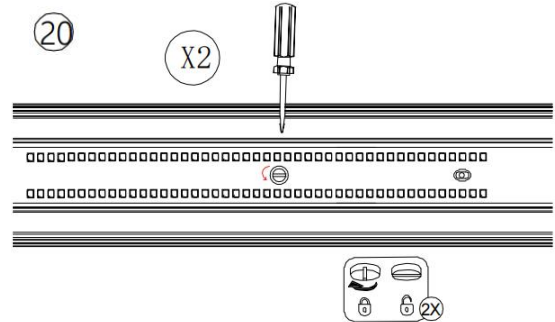

20. Use a flat screwdriver to rotate the screws on the LED board from open to lock status, do it on both side.

21

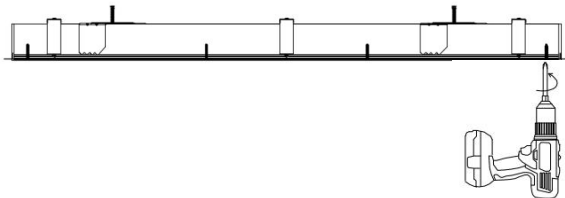

21. Secure the flange with screws.

22

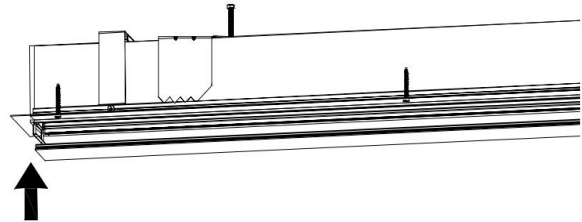

22. Carefully reinstall the lens to the fixture.

23

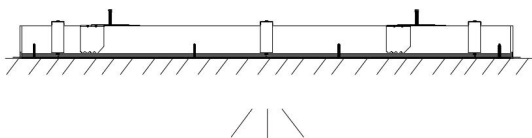

23. The installation is complete.

Specifications and dimensions subject to change without notice.